

Contractor Single Dreamscreen (applies to both single and double doors) CUTTING & ASSEMBLING the Contractor Dreamscreen

(These instructions do NOT apply to standard or custom Dreamscreen units)

DO NOT UNWRAP THE ASSEMBLY! Using the height measurement from the previous steps, the Dreamscreen can be cut to the correct length. Open the Dreamscreen carton and remove the screen assembly. Included in the wrapped assembly is the screen rolled onto the screen tube with the pull rail, the screen housing, and the jamb and jamb support. The parts packages, the spring assembly and the 48" guide rails are not part of the screen assembly.

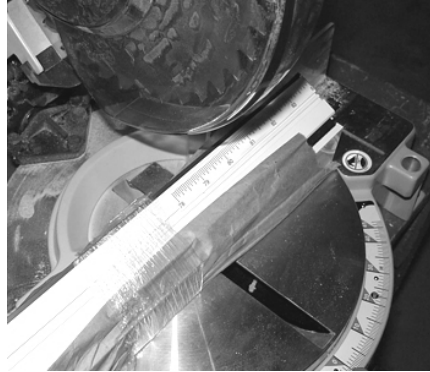
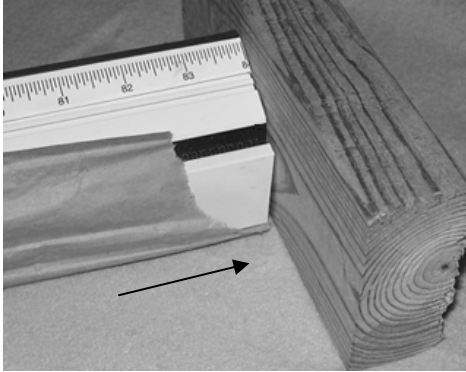

- 1 One end of the wrapped assembly has all the same lengths. This is the end that will be cutoff. It also has a "measuring tape" label that is used to measure the length to be cut. Check that all the pieces and screen are flush with a block prior to cutting.

Line up the saw blade to the dimension on the "measuring tape" label that corresponds to the Dreamscreen height measurement and make the cut slowly and cleanly. Use a chop saw to cutoff the assembly to the correct length. A carbide tipped blade with 80+ teeth gives a cleaner cut. Shown is 79" tall cut.

Carefully remove the clear stretch-wrap from the screen assembly after the cut is made. **BE CAREFUL NOT TO CUT THE SCREEN OR SCRATCH THE PAINT WHEN REMOVING THE STRETCH WRAP**, especially when using a utility knife to cut the wrapping.

If the Dreamscreen height is shorter than the dimension on the tape, use a tape measure from the end of the screen assembly (either 84" or 98" in height) to mark off the correct height. For example, for a height of 76 1/2", measure 7 1/2" from the end (84" minus 76 1/2") to mark the correct height and make the cut.

- 2 Remove the corrugated inserts between the screen and screen housing and remove the spacer from the bottom of the screen, then push the screen and tube against the bottom of the square housing until it is seated. The freshly cut end of the screen tube will be approx. 1/8" from the top edge of the square housing when correctly seated (see below).

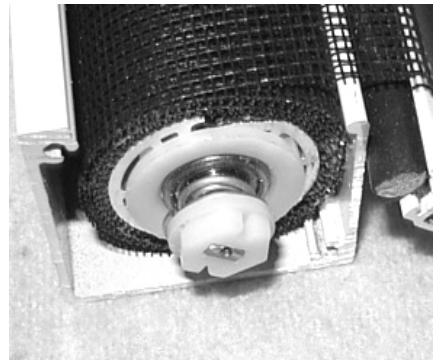
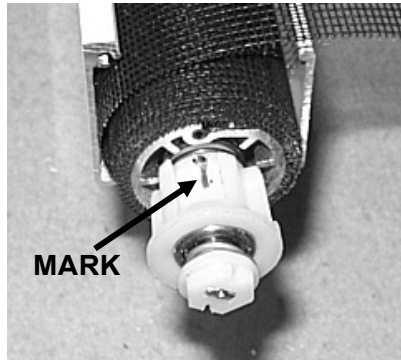

- 3 Insert the spring assembly into the open screen tube end. Align the mark on the plastic cap with the round cutout in the tube as shown above. It will only fit correctly if one location in the tube. **DO NOT FORCE THE SPRING ASSEMBLY INTO THE TUBE.** It will slide easily in place when it is correctly aligned.

Contractor Single Dreamscreen (applies to both single and double doors)

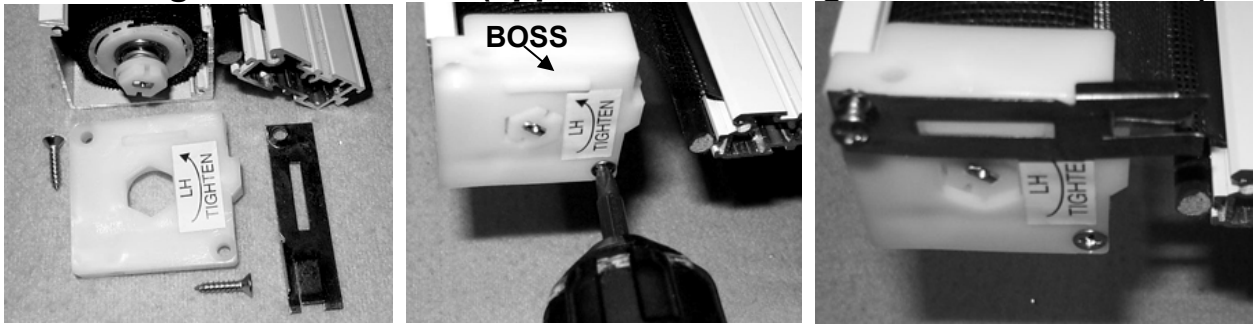

4

Remove the plastic housing end cap, the housing clip, (2) #6 x 5/8" long flathead screws from the parts package. Assemble the end cap to the housing making sure that the hex insert lines up with the hex opening in the end cap. Note the orientation of the housing cap relative to the housing, with the boss along the open end of the square housing. Locate the housing clip in place when fastening the screw. The clip must line up with the rectangular boss on the housing cap and must sit flush with the top of the cap.

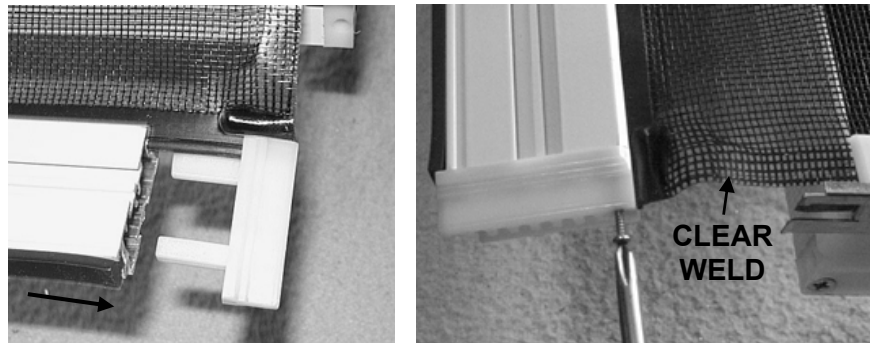

5

Remove the lower pull rail end caps and one small pan head screw from the parts package. Slide the lower end cap onto the screen spline as shown, (the clear welded edge of the screen is at this end). Slide the metal pull rail bar over the end cap prongs, and use the small #2 x 3/8" screw to hold the end cap.

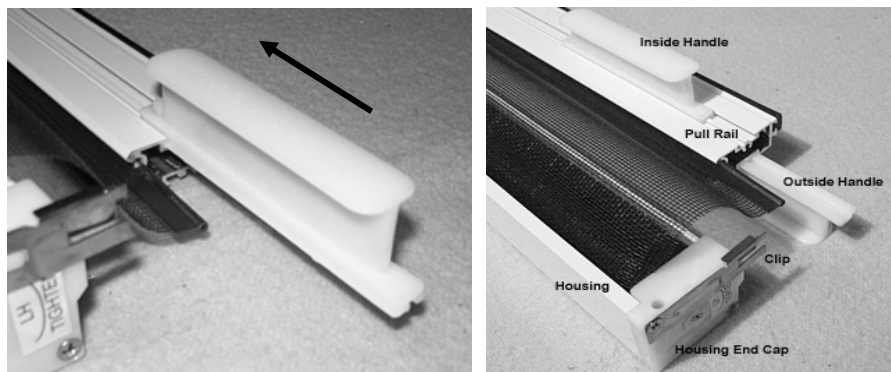

6

Install the two plastic handles, one on each side of the pull rail, by sliding them into the center groove of the pull rail. Insert the handle end with the set screw first. Tighten the set screws with the handles approximately in the middle of the pull rail, the exact height can be adjusted later.

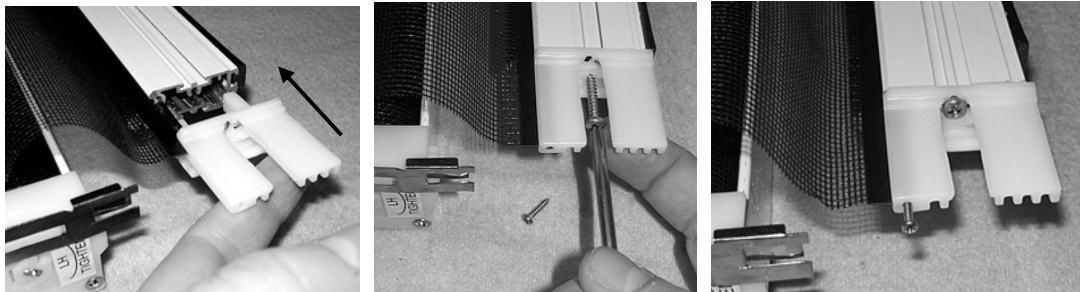

7

Mount the upper (deep) end cap by first using the large pan head screw (do not over tighten). Tighten the small screw until the spline is all the way to the end, making the screen taut.

Contractor Single Dreamscreen (applies to both single and double doors)

8

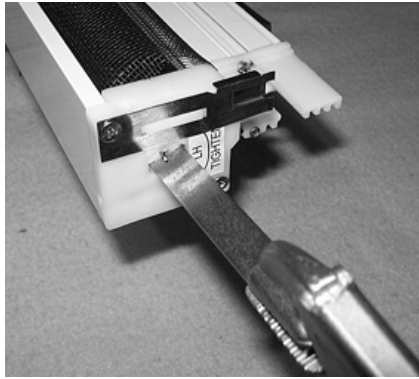

Next, the tension is wound into the spring assembly using the tension adjusting wrench from the parts package. Vice grips used to hold the wrench will simplify this procedure. Set the bottom of the screen housing against a positive stop (a wall, a post, etc.) to keep it from sliding when applying pressure. Insert the wrench into the two notches in the hex insert and push in so that the hex insert releases itself from the end cap and allows it to rotate. Turn the wrench clockwise for Right Hand doors and counter clockwise for Left Hand doors **as marked on the label on the end cap.**

Under normal circumstances, make 24 full rotations on a door up to 84" and 27 turns for an 8 ft high door. You may add another 2 turns in applications for high-rise buildings or unusually strong wind conditions to help prevent wind blowout. **Be very careful when removing the wrench so that the hex insert lines up with the hex in the end cap opening. Back the wrench out very slowly until you can see that the hexes are aligned.**

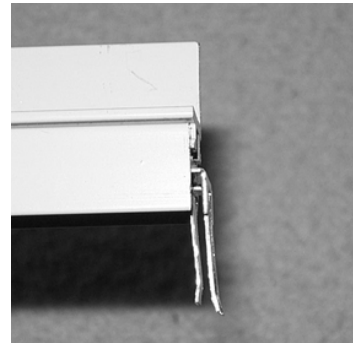
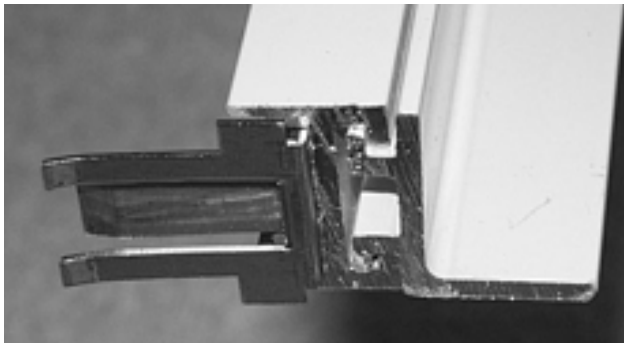

9

Remove the two jamb clips from the parts package. Insert one in each end of the jamb **behind the magnet** (as shown) in between the magnet and the jamb extrusion. They may be difficult to slide in place so you may want to tap them in place with the end of a screwdriver or a soft hammer. For double doors, step 9 is not required.

You are now ready for installation!